

BUILD ROME IN A DAY CLASS PROJECT

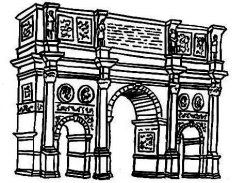

Maybe Rome wasn't built in a day, but on _____ (due date) you and your classmates will build ancient Rome!

THE ASSIGNMENT:

In this packet are listed the important monuments of the ancient city of Rome at the height of its grandeur. Working individually or in pairs or groups of three, **students will build the monuments of imperial Rome, and then together the class will reconstruct the city.**

On _____ (due date), the class will assemble all of the buildings to create a walk-through model of ancient Rome. The model will be on display all day, and students will wear togas and give tours in honor of their accomplishment.

REQUIREMENTS:

1. In order for the buildings fit together, they must all be built to the same scale. Complete instructions for drawing the blueprint for your monument to scale can be found in this packet.
2. Suggested materials for construction: foam board, Styrofoam, poster board, and cardboard. White straws or coffee stirrers, lollipop sticks and small wooden dowels make good columns. Building materials may not be edible.
3. You will also fill out an information chart on your monument. You will find the data for this chart by researching your monument on the Internet. This chart can be found in this assignment packet. You will use the information from your chart to give a short presentation on your monument on the day we set up Rome and give tours of the city.
4. On _____ (due date), you will bring your monument to _____ (location for setup), where we will build Rome in a day!

DEADLINES:

_____ (date) Parent signature form due
_____ (date) Monument blueprint due
_____ (date) Information chart due
_____ (date) Completed project due (Bring the project to _____ (location) and (optional) bring a twin-sized bed sheet to wear as a toga.)

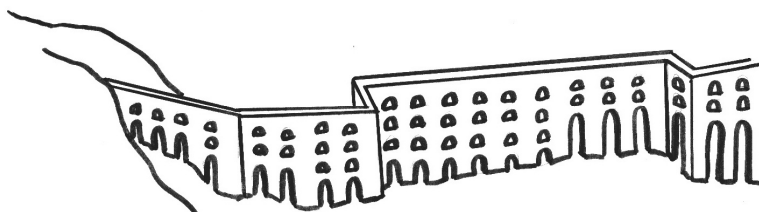

Monuments List

(S) = small (M) = medium (L) = large

1:12 Scale Monuments

(Most are located in the Roman Forum)

- (S) Temple of Juno Moneta (1)
- (S) Tabularium (2)
- (S) Temple of Concord (3)
- (S) Temple of Vespasian (4)
- (S) Senate House (Curia) (5)
- (S) Temple of Saturn (6)
- (S) Monuments of the Roman Forum (7) (Arch of Septimius Severus, Rostra, Triumphal Columns, Column of Phocas, and Equestrian Statue of Constantine)
- (M) Basilica Aemilia (8)
- (S) Temple of Vesta (9) & Arch of Constantine
- (S) Temple of Divine Julius Caesar (10)
- (S) Temple of Antoninus and Faustina (11)
- (S) Temple of Romulus (12)
- (M) Basilica Maxentius (or Constantine) (13)
- (M) House of the Vestals (14)
- (S) Temple of Castor and Pollux (15)
- (M) Basilica Julia (16)
- (S) Temple of Fortuna Virilis & Temple of Hercules
- (S) Septizodium

(The number in parentheses refers to the key on the "Roman Forum Detail Map")

1:24 Scale Monuments

- (M) Trajan's Column and surrounding courtyard
- (L) Trajan's Forum and Basilica
- (M) Trajan's Market
- (M) Forum of Augustus and Temple of Mars
- (M) Forum of Julius Caesar
- (M) Forum of Nerva and Temple of Minerva
- (L) Temple of Peace (Forum Pacis)
- (L) Temple of Venus and Roma
- (L) Colosseum (Coliseum)
- (L) Circus Maximus
- (L) Imperial Palace (central section of the Domus Augustiana) (Palatine)
- (L) Stadium of Domitian
- (L) Temple of Deified Claudius
- (M) Theater of Marcellus
- (L) Theater of Pompey
- (M) Odeon of Domitian
- (L) Pantheon
- (M) Mausoleum (Tomb) of Hadrian
- (M) Mausoleum (Tomb) of Augustus
- (M) Temple of Jupiter Capitolinus
- (M) Claudian Aqueduct (Aqua Claudia)
- (S) Column of Marcus Aurelius & surrounding courtyard
- (M) Tiber Island
- (L) Baths of Caracalla
- (L) Baths of Trajan
- (L) Baths of Diocletian

Building Your Model to Scale

You will find two maps in this packet: (1) the “Layout of the Rome Model Map,” which shows all of the monuments that your class can build, and (2) the “Roman Forum Detail Map,” which shows just the buildings of the Roman Forum. Relative to these maps, the scale of the models you will build will be as follows:

- “Layout of the Rome Model Map”: 1 inch on the map = 24 inches on the model
- “Roman Forum Detail Map”: 1 inch on the map = 12 inches on the model

Larger monuments will be built according to a scale of 1:24, as shown on the “Layout of the Rome Model Map,” with 1 inch on the map representing 24 inches on the model. Since the buildings in the Roman Forum are smaller, they are shown on the “Roman Forum Detail Map” with the scale of 1:12, with one inch on the map representing 12 inches on the model. ***The small blueprint grid you will receive for your monument is drawn to the correct scale for your model and indicates whether you will be using a 1:24 or a 1:12 scale.***

Creating the Blueprint for your Monument

Using the small blueprint grid of your monument, which you will receive from your teacher, you will create a large blueprint of your monument, which will represent the exact size and shape of the base of the structure that you will be building.

First, draw a large grid for your blueprint

- Draw the number of squares indicated on your small blueprint. You will need a piece of paper for your blueprint that is at least the size indicated on your small blueprint. (A small building like the Temple of Divine Julius Caesar might only require an 8½” x 11” piece of paper, while the a large monument like the Circus Maximus will require a piece of paper that is at least 6 feet long and 1½ feet wide.)
- Be sure to draw your squares the correct size for your monument’s scale. If your monument uses a scale of 1:24, use 6-inch squares on your grid. If your monument uses a scale of 1:12, use 3-inch squares on your grid.

Here's the math:

If your monument uses a scale of 1:24, the "small blueprint" on the "Small Blueprint and Information Card" was taken from the "Layout for the Rome Model Map." 1 inch on this map = 24 inches on the model.

If your monument uses a scale of 1:12, the "small blueprint" on the "Small Blueprint and Information Card" was taken from the "Roman Forum Detail Map." 1 inch on this map = 12 inches on the model.

Each box on the grid on your small blueprint is $\frac{1}{4}$ square inch, or 4 boxes per inch.

Therefore, for the grid on your enlarged blueprint:

- For a monument with a 1:24 scale: the size of a box = $\frac{1}{4}$ of 24 = 6 square inches (6 inches x 6 inches)
- For a monument with a 1:12 scale: the size of a box = $\frac{1}{4}$ of 12 = 3 square inches (3 inches x 3 inches)

- Now, look at the small blueprint, and using the shape on the small grid as a guide, draw the shape of the base of the monument onto your enlarged grid.
 - Use pencil. Unless you are an incredible draftsman, you will need to erase.
 - Note where the line crosses the grid at each point. Is it halfway between one intersection and the next, a quarter of the way? Does it cross above or below the intersection? Keep comparing the small blueprint to the large one as you draw.

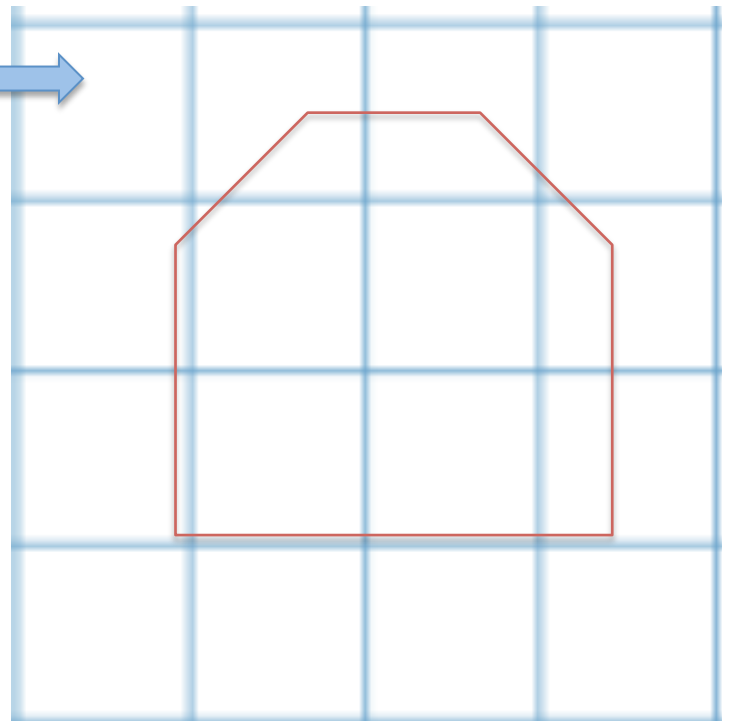
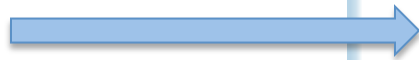
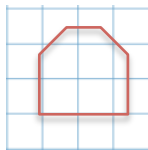

- When you are finished, you should have a blueprint showing the exact dimensions for the base of the model of your monument.
- Unfortunately, determining the height is more difficult and it is not an exact science. You will have to estimate the height by looking at pictures of the monument. Look to see if the building appears taller than it is wide, shorter, or about the same. Then estimate the proportion. Does it look like it is twice as tall as it is wide, half as tall, $\frac{2}{3}$ as tall? Then go with your best estimate

Layout of the Rome Model (scale from this map to the model = 1:24)

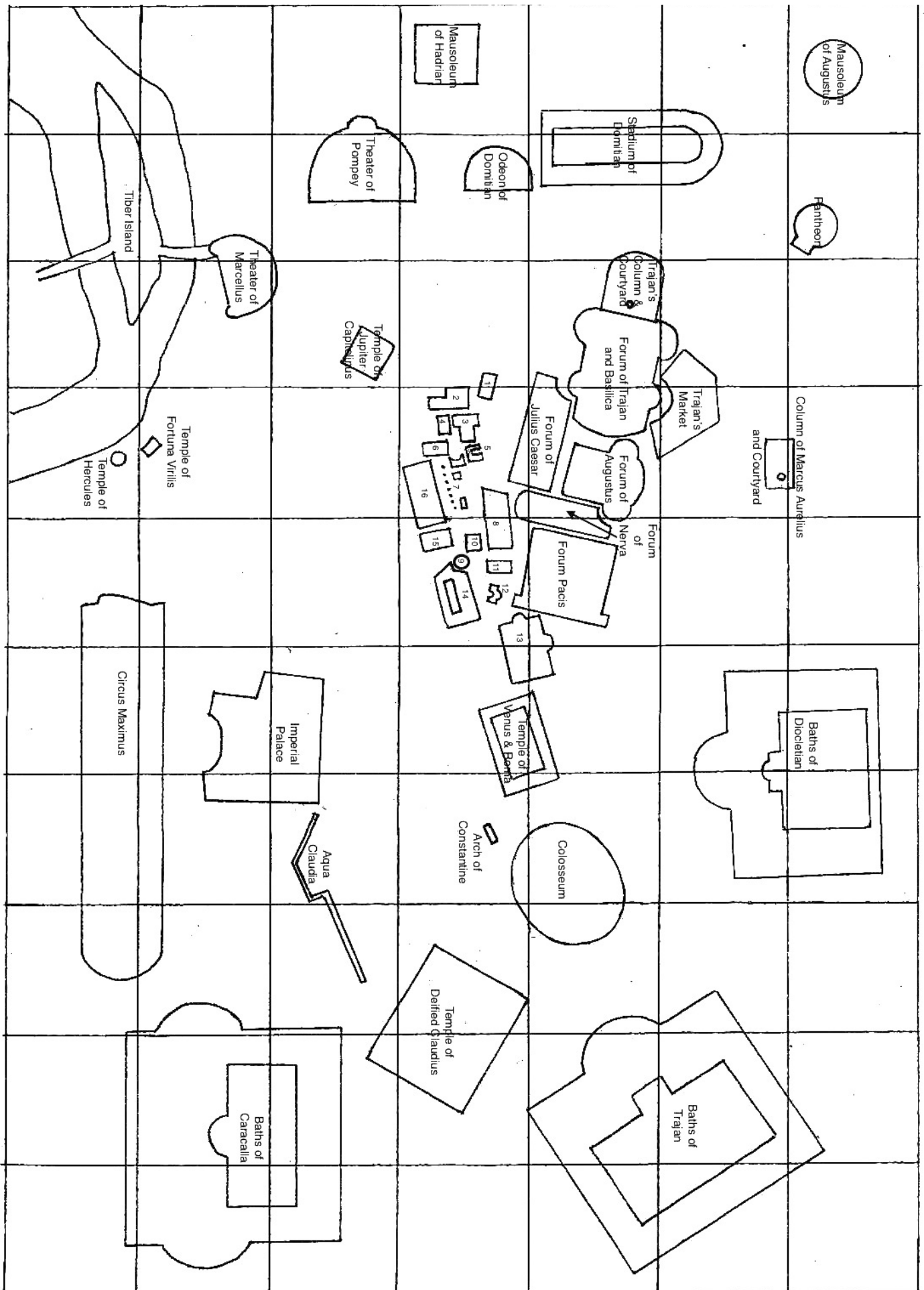

Roman Forum Detail Map

(scale from this map to the model = 1:12)

- | | |
|-------------------------|--|
| 1 Temple of Juno Moneta | 9 Temple of Vesta |
| 2 Tabularium | 10 Temple of Divine Julius Caesar |
| 3 Temple of Concord | 11 Temple of Antoninus and Faustina |
| 4 Temple of Vespasian | 12 Temple of Romulus |
| 5 Senate House | 13 Basilica Maxentius (or Constantine) |
| 6 Temple of Saturn | 14 House of the Vestals |
| 7 Roman Forum Monuments | 15 Temple of Castor and Pollux |
| 8 Basilica Aemilia | 16 Basilica Julia |

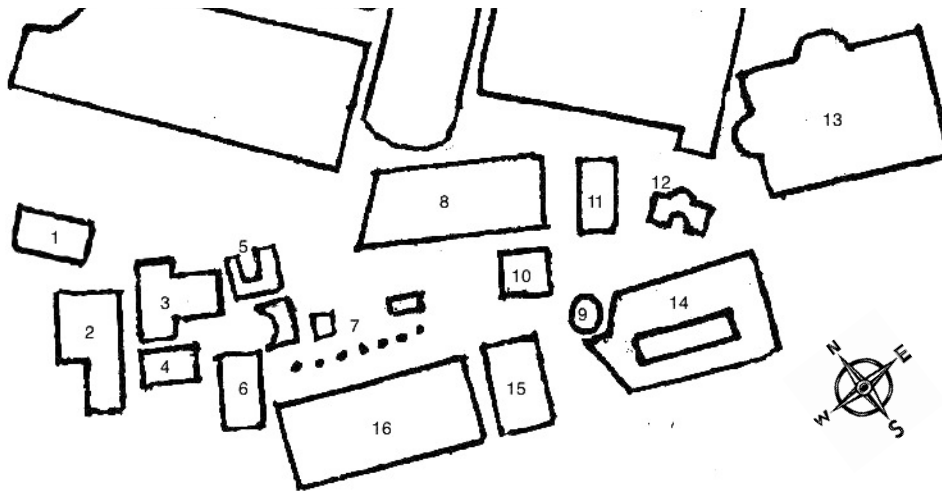

Rome Landmark Information Chart

Your Name:

Period:

Landmark:

Who? Who designed or had this landmark built? (In some cases, this is unknown.)	
What? What was it for? Describe any notable architectural features.	
When? When was the landmark built? Rebuilt?	
Fun Facts: Two or three fun facts:	

Bibliographical information:

Parent Signature Form

Print student's name _____

Per.# _____

Monument _____

Dear Parents,

Your child will be working on a construction project in which the class will be “building Rome in a day.” Each individual student or pair or trio of students will construct one of the many monuments of ancient Rome at home, and then on _____ (due date) the students will bring them to school and we will assemble the city of Rome.

Please remember that while your encouragement and support are welcome in this project, students should do the work themselves. Parents may only assist with aspects of the project that could be dangerous, such as sawing or cutting with a utility knife. ***Any parental contributions should be noted on an index card attached to the project.***

Parents are invited to come view our model of Rome and attend the student-led tours.

Please review the following deadlines with your child:

_____ (date) Parent signature form due

_____ (date) Monument blueprint due

_____ (date) Information chart due

_____ (date) Completed project due (Bring the project to _____ (location) and (optional) have your child bring a twin-sized bed sheet to wear as a toga.)

Parent Signature

Date